

Plotted By: Willson, Teresa - Sheet Set: BREWERY - LAYOUT: C4.01 DUMPSTER CIRCULATION PLAN - December 23, 2024 - 10:14:19am - K:\VTL-Civil\044-libs\044203010-Cypress Nook\CAD\Plansheet - Brew Fish Brewery\C4.01 DUMPSTER AUTOTURN PLAN.dwg

This document, together with the concepts and designs presented herein, as an instrument of service, is intended only for the specific purpose and client for which it was prepared. Reuse of and improper reliance on this document without written authorization and adaptation by Kimley-Horn and Associates, Inc. shall be without liability to Kimley-Horn and Associates, Inc.

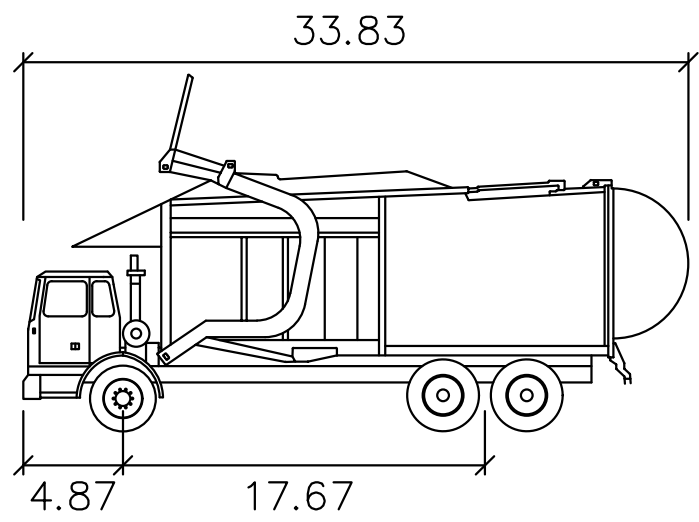
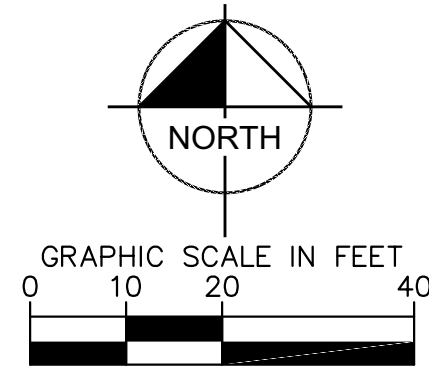
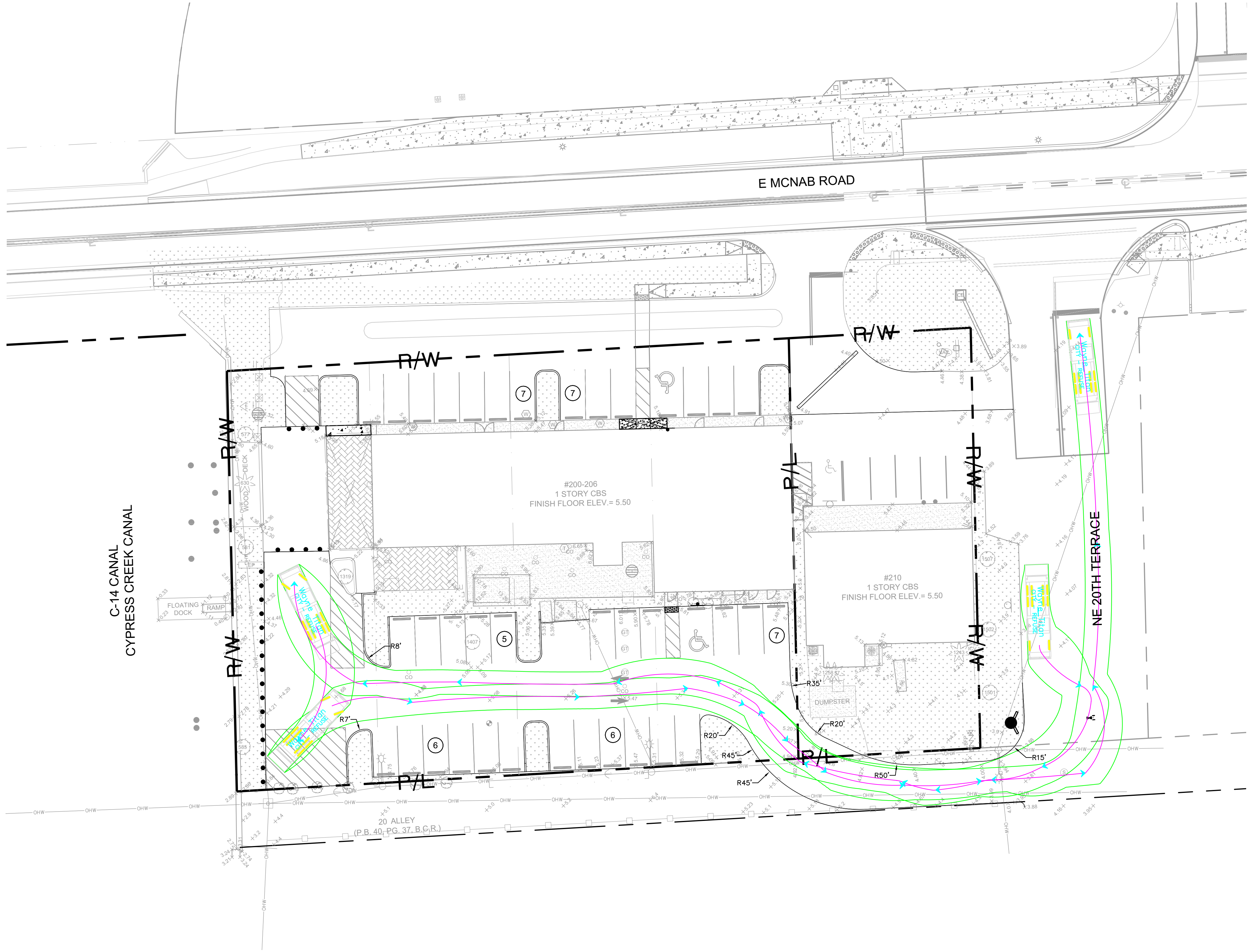

Wayne Titan

Width	: 8.46
Track	: 8.00
Lock to Lock Time	: 6.0
Steering Angle	: 45.0

Digitally signed
by George
Balaban
Date:
2024.12.23
13:13:02 -05'00'

GEORGE BALABAN, STATE OF FLORIDA, PROFESSIONAL
ENGINEER, LICENSE NO. 74543

THIS ITEM HAS BEEN DIGITALLY SIGNED AND SEALED BY
GEORGE BALABAN, P.E. ON THE DATE INDICATED HERE.

PRINTED COPIES OF THIS DOCUMENT ARE NOT CONSIDERED
SIGNED AND SEALED AND THE SIGNATURE MUST BE VERIFIED
ON ANY ELECTRONIC COPIES.

PLANS ARE IN NAVD 1988 DATUM
CONVERSION EQUATION IS BELOW:
(NAVD 1988) + 1.58' = (NGVD 1929)

THE PRESENCE OF GROUNDWATER SHOULD BE
ANTICIPATED. CONTRACTOR'S BID SHALL
INCLUDE CONSIDERATION FOR ADDRESSING THIS
ISSUE AND OBTAINING ALL NECESSARY PERMITS.

Always call 811 two full business days before you dig to
have underground utilities located and marked.

Sunshine811.com

BREW FISH BREWERY PREPARED FOR CITY OF POMPANO BEACH CITY OF POMPANO BEACH	DUMPSTER CIRCULATION PLAN	KHA PROJECT 044203010 DATE DEC. 2024 SCALE AS SHOWN DESIGNED BY TVC DRAWN BY TVC CHECKED BY GB	LICENCED PROFESSIONAL GEORGE BALABAN, P.E. FL LICENSE NUMBER 74543 DATE: 12/11/2024	Kimley»Horn © 2024 KIMLEY-HORN AND ASSOCIATES, INC. 8201 PETERS ROAD, SUITE 2200, PLANTATION, FL 33324 PHONE: 954-535-5100 FAX: 954-739-2247 WWW.KIMLEY-HORN.COM REGISTRY No. 35106	1 CITY COMMENTS	REVISIONS	No.	BY	12/19/24 TVC
									DATE